

DETALIU IMPREJMUIRE PLASA BORDURATA

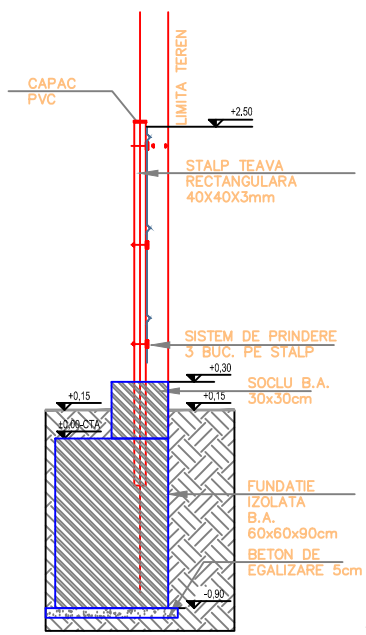

DETALIU POARTA

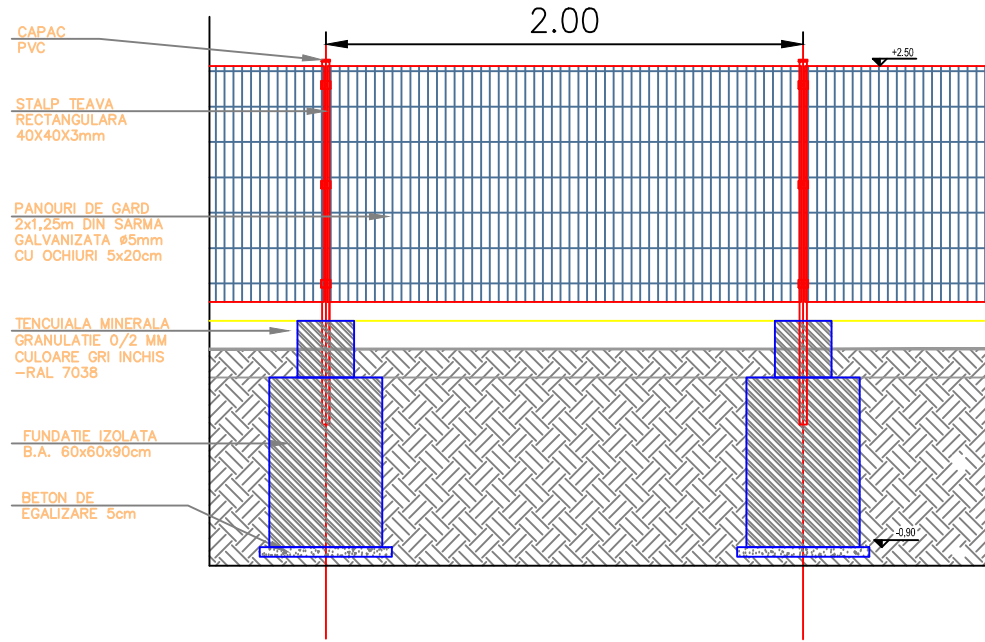
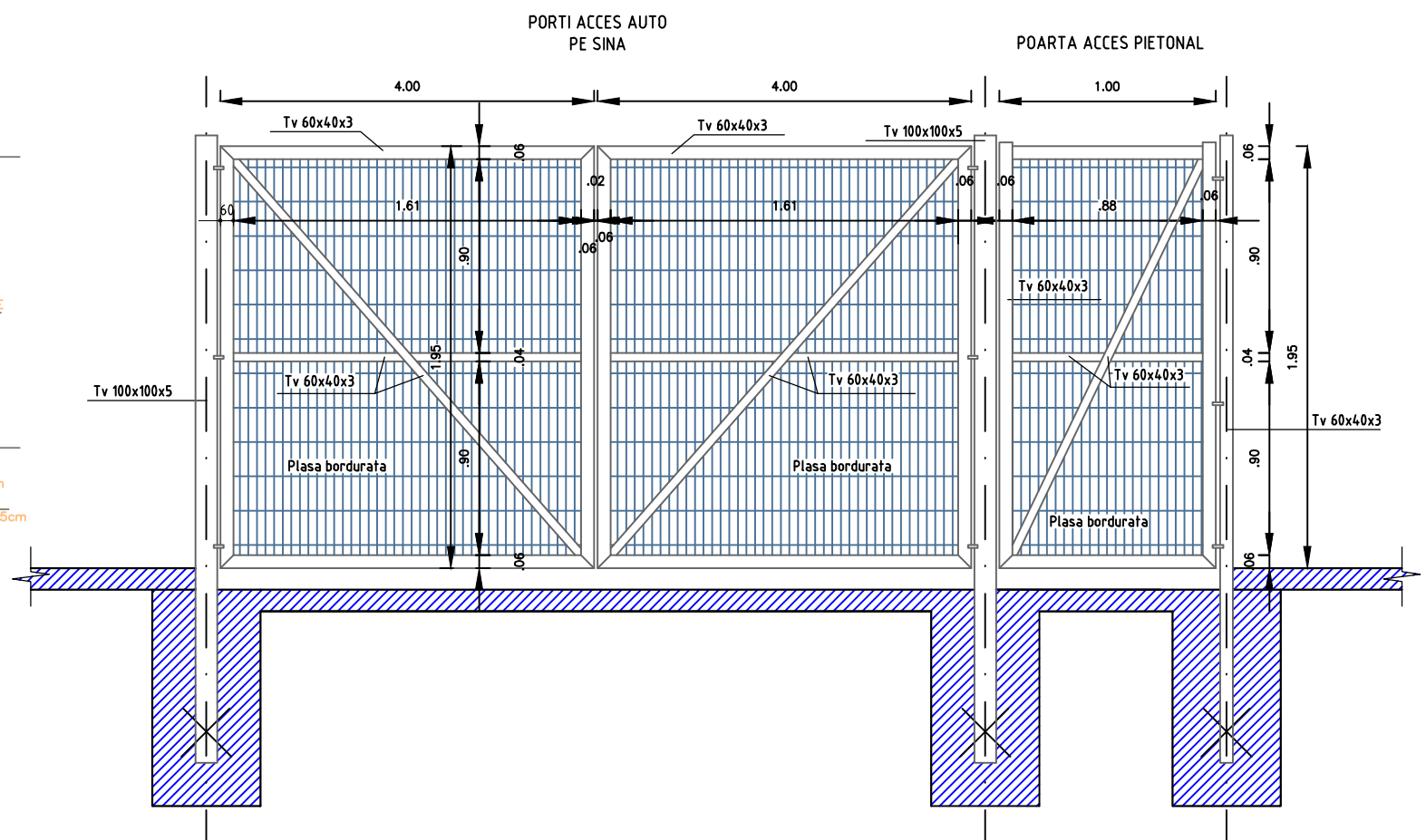

1. Categoria de importanta: D, conform HG766/1997;
2. Clasa de importanta: IV, conform P100-1/2013;
3. Zona de vant qb = 0.5 kPa, conform CR-1-1-4-2012;
4. Zona de zapada: sk = 1.5 KN/mp, conform CR-1-1-3-2012;
5. Zona seismica: ag = 0.20, Tc = 0.7s, conform P100-2013,

PROIECTANT GENERAL:		BENEFICIAR:		NR. PROIECT: 252/2023
		SC ADRISIMO 27 S.R.L. Amplasament: Medgidia, parcela 290/1/2, Jud. Constanta, CF Nr. 110335		
TITLU PROIECT:				
INTRARE IN LEGALITATE PENTRU CONSTRUIRE PLATFORMA BETONATA, IMPREJMUIRE, BIROURI, CANTAR, STATIE MOBILA SI ANEXE				
FAZA:		D.T.A.C. P.T.		
Specificatie		Semnatura	SCARA	TITLU PLANSA:
Sef proiect	Arh. George-Andrei URETU		1:25	PLAN DETALII IMPREJMUIRE
Proiectat	Arh. George-Andrei URETU		DATA	
Desenat	Op. Alexandru FIRSA		09.2023	
				PLANSA NR. A03
				FORMAT: A3
				index borderou